

# ALPOLIC® MATERIALS

MITSUBISHI PLASTICS COMPOSITES AMERICA, INC.

## architectural – metallic

ALPOLIC® architectural Metallic color aluminum composite materials are manufactured with a polyethylene core and a 3-coat fluoropolymer paint finish. The Metallic panels provide a brilliant finish to any building project.

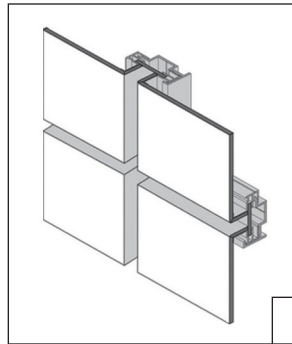

### CONSTRUCTION INFORMATION

PROJECT: Winnie Palmer Hospital

LOCATION: Orlando, FL

ARCHITECT: Jonathan Bailey Associates

PRODUCT: ALPOLIC® Mica Platinum &  
Medium Bronze Metallic



### GENERAL INFORMATION

ALPOLIC®'s extensive selection of Metallic finishes enable you to create designs and effects that no other panel system can achieve. They are stocked in two widths – 50 and 62 inches; and two lengths – 146 and 196 inches. These 4mm-thick panels are manufactured to architectural standards with a traditional polyethylene core.

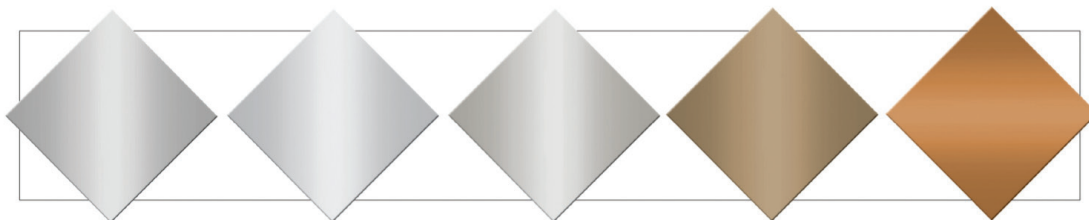

*SMX SILVER  
METALLIC  
4-4SMX-G30*

*BSX SILVER  
METALLIC  
4-4BSX-G30*

*CHAMPAGNE  
METALLIC  
4-4CMX-G30*

*MEDIUM BRONZE  
METALLIC  
4-4MBX-G30*

*DARK COPPER  
METALLIC  
4-4DCX-G30*

## SURFACE TREATMENT

ALPOLIC® architectural Metallic color panels are stocked with a FEVE LUMIFLON™ or a PVDF Kynar finish, both are fluoropolymer paint systems that feature excellent durability and weathering for architectural needs. Available stock architectural Metallic colors include SMX Silver Metallic, Champagne Metallic, Medium Bronze Metallic, Dark Copper Metallic and BSX Silver Metallic.

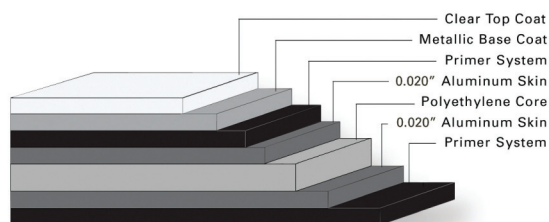

## STANDARD PANEL SIZE

Standard stock widths are 50" (1270mm) and 62" (1575mm) and lengths of 146" (3708mm) and 196" (4978mm). Panels are stocked in 4mm thickness. Standard crate is 50 pieces. Custom lengths and thickness available. Please contact ALPOLIC® Customer Service for current available stock and additional information.

## FINISH TOLERANCE

Color: DE 2.5 max from standard  
Gloss: Nominal +/- 10 units

## PRODUCT TOLERANCE

Width:  $\pm 0.08"$  (2mm)  
Length:  $\pm 0.16"$  (4mm)  
Thickness:  $4\text{mm} \pm 0.008"$  (0.2mm)  
 $6\text{mm} \pm 0.012"$  (0.3mm)  
Bow: maximum 0.5% of length and/or width  
Squareness: maximum 0.2" (5mm)  
Peel Strength: >22 in lb/in (ASTM D1781)

ALPOLIC® material is trimmed and squared with cut edges to offer the best panel edge conditions in the industry.

## FIRE PERFORMANCE

Standard ALPOLIC® architectural Metallic finish panels with a polyethylene core have been tested by independent testing laboratories using nationally recognized tests.

This material meets all requirements of the International Building Code for combustible construction:

IBC Listed  
UL Listed

Please visit [www.alpolic-northamerica.com](http://www.alpolic-northamerica.com) or call technical support for complete report listings and additional information.

## WARRANTY

Standard panel warranty: 10 Year  
Finish warranty: 30 Year\*  
Call ALPOLIC® Customer Service for exclusions and warranty details. \*30 year warranty only applies to standard architectural colors.

## PRODUCT NOTES

- Panels should be stored flat in a dry, indoor environment.
- Fabricate panels at temperatures above 55°F.
- Protective film should be removed from panels soon after installation.
- Please refer to ALPOLIC® Painted ACM Fabrication Manual for routing and fabrication recommendations.
- Crating fees apply to orders for less than standard piece crate.
- For best color consistency, ALPOLIC® recommends ordering all required Metallic paint finish panels at one time and maintaining consistent panel orientation during installation.
- Different lots of Metallic finishes should not be mixed on building elevation.

**FOR TECHNICAL INFORMATION, PLEASE  
CALL 1.800.422.7270**

### U.S. HEADQUARTERS

**MITSUBISHI PLASTICS COMPOSITES AMERICA, INC.**

401 Volvo Parkway, Chesapeake, VA 23320

Telephone: 800-422-7270, Facsimile: 757-436-1896

[www.alpolic-northamerica.com](http://www.alpolic-northamerica.com) e-mail: [info@alpolic.com](mailto:info@alpolic.com)