

ALPOLIC®

MATERIALS

MITSUBISHI PLASTICS COMPOSITES AMERICA, INC.

architectural – solid

ALPOLIC® architectural Solid color aluminum composite materials are manufactured with a polyethylene core and a 2-coat fluoropolymer paint finish. Distinctive classics of the industry, they are stocked for immediate shipment.

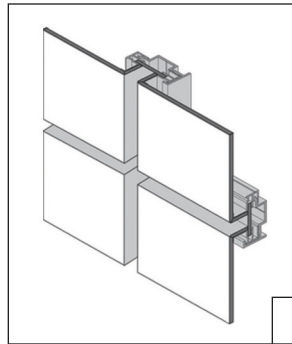

CONSTRUCTION INFORMATION

PROJECT: Ashland Community College

LOCATION: Grayson, KY

ARCHITECT: Clotfelter-Samokar

PRODUCT: ALPOLIC® Mist White & KDX



GENERAL INFORMATION

Picture your next project in attractive, clean colors and designs that only our lightweight aluminum composite material (ACM) panels can achieve. They are stocked in two widths – 50 and 62 inches; and two lengths – 146 and 196 inches. These 4mm-thick panels are manufactured to architectural standards with a traditional polyethylene core.

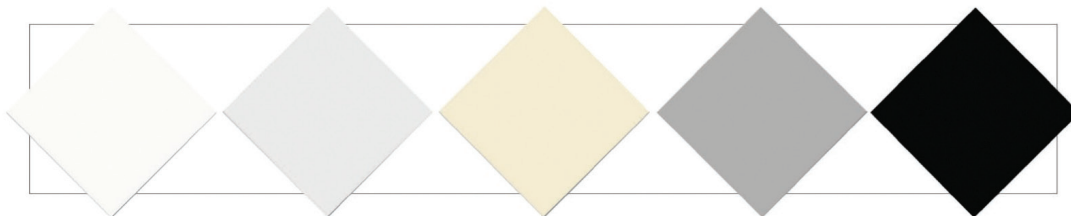

BONE WHITE
4-4BNT-G30

MIST WHITE
4-4MST-G30

OYSTER
4-4CRT-G30

ALUMINUM GREY
4-4AGT-G30

TOB BLACK
4-4TOB-G15

ALPOLIC®

solid

INTERIOR AND EXTERIOR SURFACING
INTERIOR AND EXTERIOR SIGNAGE

SURFACE TREATMENT

ALPOLIC® architectural Solid color panels are stocked with a FEVE LUMIFLON™ or a PVDF Kynar finish, both are fluoropolymer paint systems that feature excellent durability and weathering for architectural needs. Available stock architectural Solid colors include Bone White, Mist White, Oyster, Aluminum Grey, BGY Grey, and TOB Black.

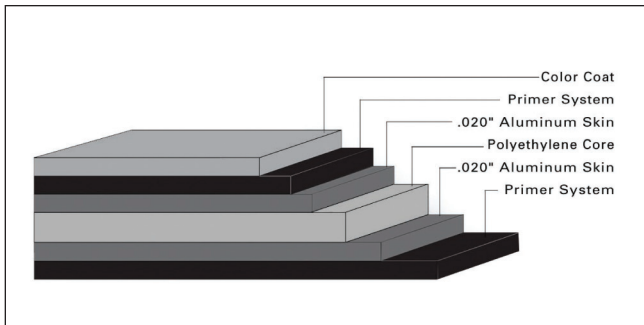

STANDARD PANEL SIZE

Standard widths are 50" (1270mm) and 62" (1575mm) and lengths of 146" (3708mm) and 196" (4978mm). Panels are stocked in 4mm thickness. Standard crate is 50 pieces. Custom lengths and thickness available. Please contact ALPOLIC® Customer Service for current available stock and additional information.

FINISH TOLERANCE

Color: DE 1.0 max from standard
Gloss: Nominal +/- 10 units

PRODUCT TOLERANCE

Width: ± 0.08" (2mm)
Length: ± 0.16" (4mm)
Thickness: 4mm ± 0.008" (0.2mm)
6mm ± 0.012" (0.3mm)
Bow: maximum 0.5% of length
and/or width
Squareness: maximum 0.2" (5mm)
Peel Strength: >22 in lb/in (ASTM D1781)

ALPOLIC® material is trimmed and squared with cut edges to offer the best panel edge conditions in the industry.

FIRE PERFORMANCE

Standard ALPOLIC® architectural Solid finish panels with a polyethylene core have been tested by independent testing laboratories using nationally recognized tests.

This material meets all requirements of the International Building Code for combustible construction:

IBC Listed
UL Listed

Please visit www.alpolic-northamerica.com or call technical support for complete report listings and additional information.

WARRANTY

Standard panel warranty: 10 Year
Finish warranty: 30 Year*

Call ALPOLIC® Customer Service for exclusions and warranty details. *30 year warranty only applies to standard architectural colors.

PRODUCT NOTES

- Panels should be stored flat in a dry, indoor environment.
- Fabricate panels at temperatures above 55°F.
- Protective film should be removed from panels soon after installation.
- Please refer to ALPOLIC® Painted ACM Fabrication Manual for routing and fabrication recommendations.
- Crating fees apply to orders for less than standard piece crate.

FOR TECHNICAL INFORMATION, PLEASE
CALL 1.800.422.7270

U.S. HEADQUARTERS

 MITSUBISHI PLASTICS COMPOSITES AMERICA, INC.

401 Volvo Parkway, Chesapeake, VA 23320

Telephone: 800-422-7270, Facsimile: 757-436-1896

www.alpolic-northamerica.com e-mail: info@alpolic.com