

ALPOLIC®

MATERIALS

MITSUBISHI PLASTICS COMPOSITES AMERICA, INC.

program – metallic

ALPOLIC® program Metallic aluminum composite material finishes present you with a full array of unique and eye-catching metallic colors.

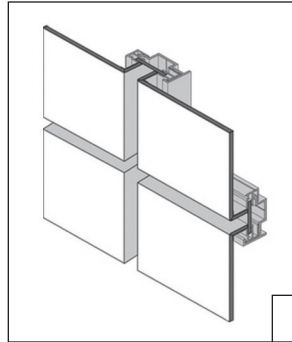

CONSTRUCTION INFORMATION

PROJECT: Town Toyota

LOCATION: East Wenatchee, WA

ARCHITECT: Scott Rice Architects

PRODUCT: ALPOLIC® TSZ Silver Metallic
& TOR Red



GENERAL INFORMATION

ALPOLIC® program Metallic panels deliver design and performance advantages inconceivable before now and add a brilliant sparkle to any structure. Panels are stocked in either 3mm or 4mm thicknesses with a traditional polyethylene core.

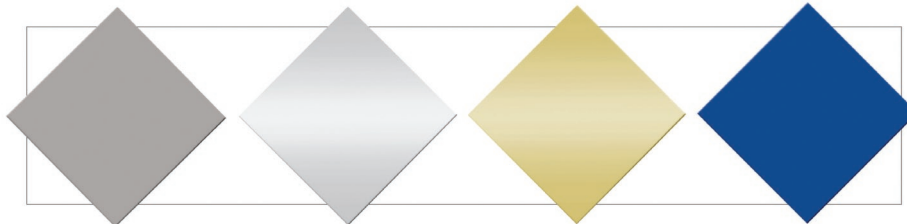

*TSZ SILVER
METALLIC
4-4TSZ-G80*

*TBX SILVER
METALLIC
3-4TBX-G30*

*GOY GOLD
METALLIC
4-4GOY-G80*

*CBZ BLUE
METALLIC
4CBZ-G80
(Custom Color)*

ALPOLIC®

metallic

INTERIOR AND EXTERIOR SURFACING
INTERIOR AND EXTERIOR SIGNAGE

SURFACE TREATMENT

ALPOLIC® program Metallic panels are stocked with a FEVE LUMIFLON™ finish, a fluorocarbon paint system that features a wide range of colors and glosses along with excellent durability and weathering for all your program needs. A PVDF, Kynar finish is available as a custom request. Available stock program colors are TBX Silver, TSZ Silver, and GOY Gold.

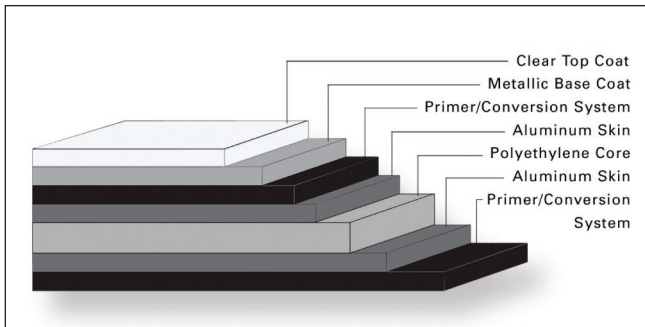

STANDARD PANEL SIZE

Standard stock sizes and thickness vary by product program. Please contact Customer Service for stock sizes. Standard crate is 75 pieces for 3mm and 50 for 4mm. Custom thickness, widths, lengths are available, along with a fire resistant core. Please contact Customer Service for current available stock and additional information.

PRODUCT TOLERANCE

| | |
|-------------|-------------------------------------|
| Width: | ± 0.08" (2mm) |
| Length: | ± 0.16" (4mm) |
| Thickness: | 3mm: ± 0.008" (0.2mm) |
| | 4mm ± 0.008" (0.2mm) |
| | 6mm ± 0.012" (0.3mm) |
| Bow: | maximum 0.5% of length and/or width |
| Squareness: | maximum 0.2" (5mm) |

ALPOLIC® material is trimmed and squared with cut edges to offer the best panel edge conditions in the industry.

FIRE PERFORMANCE

Standard ALPOLIC® program Metallic finish panels with a polyethylene core have been tested by independent testing laboratories using nationally recognized tests.

This material meets all requirements of the International Building Code for combustible construction:

IBC Listed for all .020/.020 products
UL Listed

Please visit www.alpolic-northamerica.com or call technical support for complete report listings and additional information.

WARRANTY

| | |
|--------------------------|---------|
| Standard panel warranty: | 10 Year |
| Finish warranty: 3mm | 10 Year |
| 4mm | 20 Year |

Call ALPOLIC® Customer Service for exclusions and warranty details.

PRODUCT NOTES

- Panels should be stored flat in a dry, indoor environment.
- Fabricate panels at temperatures above 55°F.
- Protective film should be removed from panels soon after installation.
- Please refer to ALPOLIC® Painted ACM Fabrication Manual for routing and fabrication recommendations.
- Crating fees apply to orders for less than standard piece crate.
- For best color consistency, ALPOLIC® recommends ordering all required Metallic paint finish panels at one time and maintaining consistent panel orientation during installation.
- Different lots of Metallic finishes should not be mixed on building elevation.

FOR TECHNICAL INFORMATION, PLEASE
CALL 1.800.422.7270

U.S. HEADQUARTERS

MITSUBISHI PLASTICS COMPOSITES AMERICA, INC.

401 Volvo Parkway, Chesapeake, VA 23320

Telephone: 800-422-7270, Facsimile: 757-436-1896

www.alpolic-northamerica.com e-mail: info@alpolic.com