

# ALPOLIC®/fr

## MATERIALS

MITSUBISHI PLASTICS COMPOSITES AMERICA, INC.

### fr architectural – prismatic

ALPOLIC®/fr architectural Prismatic finish aluminum composite panels use FEVE technology with specialized mica flake pigments in the paint composition that causes the light to reflect differently upon viewing angles. This creates a surface that shifts colors or sparkles like diamonds.

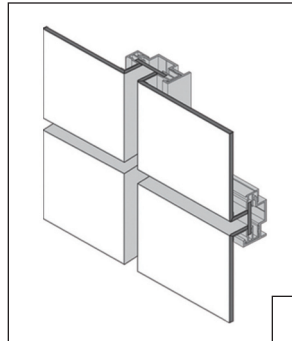

#### CONSTRUCTION INFORMATION

PROJECT: Sorensen Station Parkade & Transit Terminal  
LOCATION: Red Deer, Alberta Canada  
PRODUCT: ALPOLIC® Prismatic Magma



#### GENERAL INFORMATION

ALPOLIC® Prismatic Series creates a dramatic custom color effect that will make your image sparkle and shine. These prismatic finish panels are not stocked but are available to be manufactured to architectural standards with a mineral filled fire resistant core.

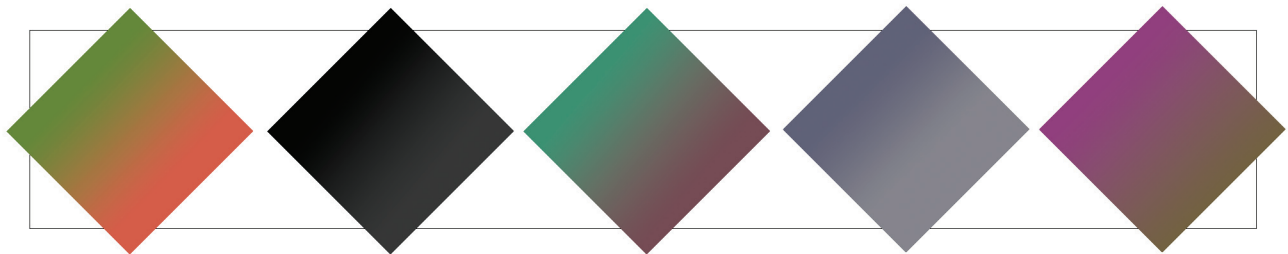

*SALMON*  
4-SVP-G70  
(Custom Color)

*ECLIPSE*  
4-SPY-G50  
(Custom Color)

*DRAGONFLY*  
4-SBP-G70  
(Custom Color)

*DUSK*  
4-RXP-G70  
(Custom Color)

*JUNE BUG*  
4-SGP-G70  
(Custom Color)

# ALPOLIC® /fr prismatic

INTERIOR AND EXTERIOR SURFACING  
INTERIOR AND EXTERIOR SIGNAGE

## SURFACE TREATMENT

ALPOLIC®/fr architectural Prismatic color panels are available with a FEVE LUMIFLON™ finish, a fluorocarbon paint system that features excellent durability and weathering for architectural needs. A PVDF, Kynar finish is available as a custom request. All 4mm Prismatic colors are custom manufactured.

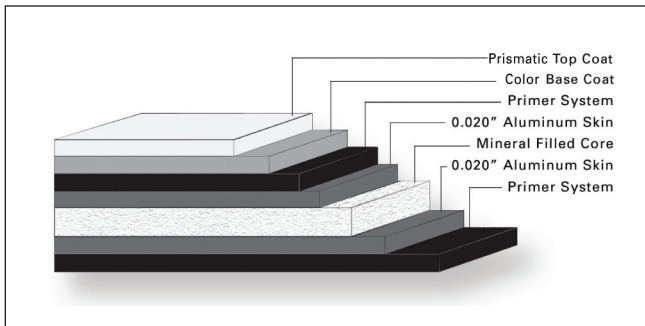

## STANDARD PANEL SIZE

Standard widths are 50" (1270mm) and 62" (1575mm) and lengths of 146" (3708mm) and 196" (4978mm). Panels can be manufactured in 4mm or 6mm thickness. Standard crate is 50 pieces. Custom lengths, widths, and thickness available. Please contact ALPOLIC® Customer Service for additional information.

## FINISH TOLERANCE

Color: DE 2.5 max from standard  
Gloss: Nominal +/- 10 units

## PRODUCT TOLERANCE

Width: ± 0.08" (2mm)  
Length: ± 0.16" (4mm)  
Thickness: 4mm ± 0.008" (0.2mm)  
6mm ± 0.012" (0.3mm)  
Bow: maximum 0.5% of length and/or width  
Squareness: maximum 0.2" (5mm)  
Peel Strength: >22 in lb/in (ASTM D1781)

ALPOLIC® material is trimmed and squared with cut edges to offer the best panel edge conditions in the industry.

## FIRE PERFORMANCE

Standard ALPOLIC®/fr architectural Prismatic finish panels with a mineral filled core have been tested by independent testing laboratories using nationally recognized tests.

This material meets all requirements of the International Building Code for combustible construction:

IBC Listed  
UL Listed

Please visit [www.alpolic-northamerica.com](http://www.alpolic-northamerica.com) or call technical support for complete report listings and additional information.

## WARRANTY

Standard panel warranty: 10 Year  
Finish warranty: 20 Year  
Call ALPOLIC® Customer Service for exclusions and warranty details.

## PRODUCT NOTES

- Panels should be stored flat in a dry, indoor environment.
- Fabricate panels at temperatures above 55°F.
- Protective film should be removed from panels soon after installation.
- Please refer to ALPOLIC®/fr Painted ACM Fabrication Manual for routing and fabrication recommendations.
- Crating fees apply to orders for less than standard piece crate.
- For best color consistency, ALPOLIC® recommends ordering all required Prismatic paint finish panels at one time and maintaining consistent panel orientation during installation.
- Different lots of Prismatic finishes should not be mixed on building elevation.

FOR TECHNICAL INFORMATION, PLEASE  
CALL 1.800.422.7270

### U.S. HEADQUARTERS

 MITSUBISHI PLASTICS COMPOSITES AMERICA, INC.

401 Volvo Parkway, Chesapeake, VA 23320

Telephone: 800-422-7270, Facsimile: 757-436-1896

[www.alpolic-northamerica.com](http://www.alpolic-northamerica.com) e-mail: [info@alpolic.com](mailto:info@alpolic.com)