

# ALPOLIC®

METAL COMPOSITE MATERIALS

MITSUBISHI CHEMICAL COMPOSITES AMERICA, INC.

## fr architectural – mica

ALPOLIC®/fr architectural Mica color aluminum composite materials are manufactured with a mineral filled fire resistant core and a 2-coat fluorocarbon paint finish. The Mica finish provides a clean, crisp look for any project.

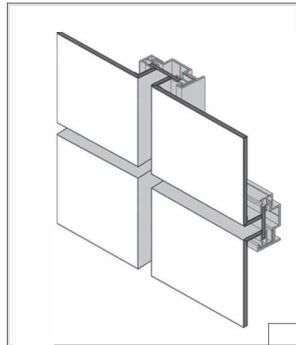

### CONSTRUCTION INFORMATION

PROJECT: Edward Jones Southwest Campus

LOCATION: Arizona

PRODUCT: ALPOLIC®/fr Mica Platinum



### GENERAL INFORMATION

ALPOLIC®'s extensive selection of Mica finishes enable you to create designs and effects that no other panel system can achieve. They are stocked in two widths – 50 and 62 inches; and two lengths – 146 and 196 inches. These 4mm-thick panels are manufactured to architectural standards with an advanced mineral filled core.

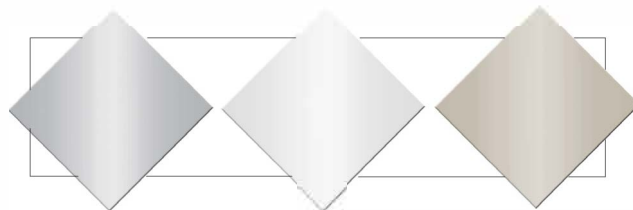

*MICA ANODIC CLEAR*  
4-4MNC-G30

*MICA PLATINUM*  
4-4OPT-G50

*MICA CHAMPAGNE*  
4-4MCU-G30

## SURFACE TREATMENT

ALPOLIC®/fr architectural Mica color panels are stocked with a FEVE LUMIFLON™ finish, a fluorocarbon paint system that features excellent durability and weathering for architectural needs. A PVDF, Kynar finish is available as a custom request. Available stock architectural Mica colors include Mica Platinum, Mica Champagne and Mica Anodic Clear.

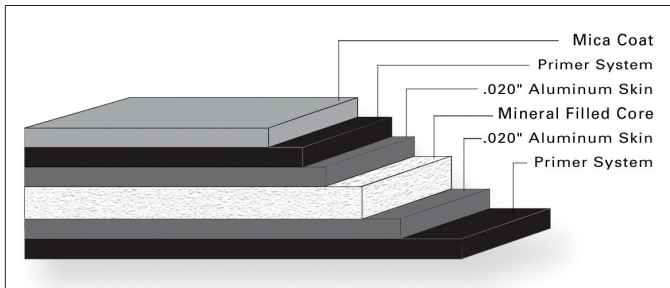

## STANDARD PANEL SIZE

Standard stock widths are 50" (1270mm) and 62" (1575mm) and lengths of 146" (3708mm) and 196" (4978mm). Panels are stocked in 4mm thickness. Standard crate is 30 pieces. Custom lengths and thickness available. Please contact ALPOLIC Customer Service for current available stock and additional information.

## FINISH TOLERANCE

Color: DE 2.5 max from standard  
Gloss: Nominal +/-10 units

## PRODUCT TOLERANCE

Width: ± 0.08" (2mm)  
Length: ± 0.16" (4mm)  
Thickness: 4mm: ± 0.008" (0.2mm)  
6mm: ± 0.012" (0.3mm)  
Bow: maximum 0.5% of length and/or width  
Squareness: maximum 0.2" (5mm)  
Peel Strength: >22 in lb/in (ASTM D1781)

ALPOLIC® material is trimmed and squared with cut edges to offer the best panel edge conditions in the industry.

## FIRE PERFORMANCE

Fire resistant ALPOLIC®/fr architectural Mica finish panels with a mineral filled core have been tested by independent testing laboratories using nationally recognized tests.

This material meets all requirements of the International Building Code for non-combustible construction:

IBC Listed

Please visit [www.alpolic-northamerica.com](http://www.alpolic-northamerica.com) or call technical support for complete report listings and additional information.

## WARRANTY

Standard panel warranty: 10 Year  
Finish warranty: 30 Year\*  
Call ALPOLIC® Customer Service for exclusions and warranty details. \*30 year warranty only applies to standard architectural colors.

## PRODUCT NOTES

- Panels should be stored flat in a dry, indoor environment.
- Fabricate panels at temperatures above 55°F.
- Protective film should be removed from panels soon after installation.
- Please refer to ALPOLIC®/fr Painted ACM Fabrication Manual for routing and fabrication recommendations.
- Crating fees apply to orders for less than standard piece crate.
- For best color consistency, ALPOLIC® recommends ordering all required Mica paint finish panels at one time and maintaining consistent panel orientation during installation.
- Different lots of Mica finish should not be mixed on building elevation.

FOR TECHNICAL INFORMATION, PLEASE  
CALL 1.800.422.7270

### U.S. HEADQUARTERS

 MITSUBISHI CHEMICAL COMPOSITES AMERICA, INC.

401 Volvo Parkway, Chesapeake, VA 23320  
Telephone: 800-422-7270, Facsimile: 757-436-1896  
[www.alpolic-americas.com](http://www.alpolic-americas.com) e-mail: [info@alpolic.com](mailto:info@alpolic.com)