

ALPOLIC®

METAL COMPOSITE MATERIALS

MITSUBISHI CHEMICAL COMPOSITES AMERICA, INC.

fr architectural – solid

ALPOLIC®/fr architectural Solid color aluminum composite materials are manufactured with a mineral filled fire resistant core and a 2-coat fluorocarbon paint finish. Distinctive classic of the industry, they are stocked for immediate shipment.

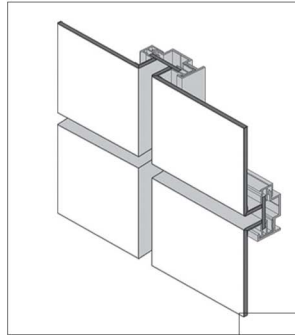

CONSTRUCTION INFORMATION



PROJECT: Georgian Towers

LOCATION: Canada

ARCHITECT: Musson Cattell Mackey

Partnership

PRODUCT: ALPOLIC®/fr Bone White

GENERAL INFORMATION

Picture your next project in attractive, clean colors and designs that only our lightweight aluminum composite material (ACM) panels can achieve. They are stocked in two widths – 50 and 62 inches; and two lengths – 146 and 196 inches. These 4mm-thick panels are manufactured to architectural standards with an advanced fire resistant core.

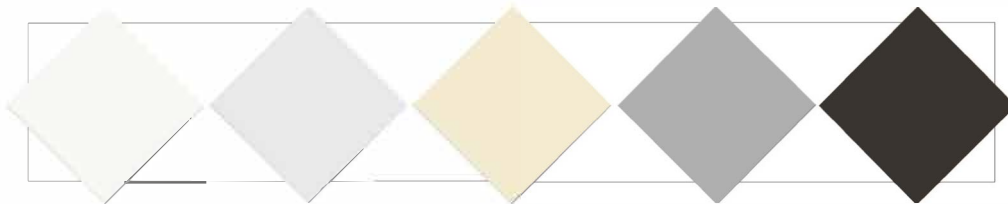

BONE WHITE
4-4BNT-G30

MIST WHITE
4-4MST-G30

OYSTER
4-4CRT-G30

ALUMINUM GREY
4-4AGT-G30

JBR BRONZE
4-4JBR-G30

ALPOLIC®/fr solid

INTERIOR AND EXTERIOR SURFACING
INTERIOR AND EXTERIOR SIGNAGE

SURFACE TREATMENT

ALPOLIC®/fr architectural Solid color panels are stocked with a FEVE LUMIFLON™ finish, a fluorocarbon paint system that features excellent durability and weathering for architectural needs. A PVDF, Kynar finish is available as a custom request. Available stock architectural solid colors include Bone White, Mist White, Oyster, Aluminum Grey, BGY Grey, and JBR Bronze.

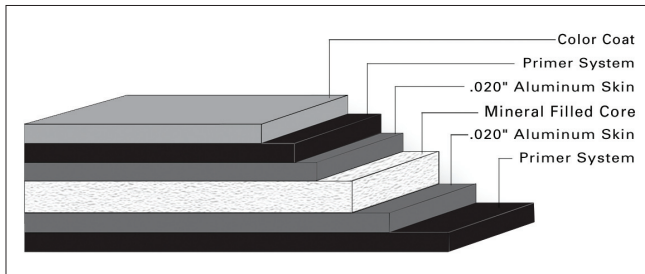

STANDARD PANEL SIZE

Standard stock widths are 50" (1270mm) and 62" (1575mm) and lengths of 146" (3708mm) and 196" (4978mm). Panels are stocked in 4mm thickness. Standard crate is 30 pieces. Custom lengths and thickness available. Please contact ALPOLIC Customer Service for current available stock and additional information.

FINISH TOLERANCE

Color: DE 1.0 max from standard
Gloss: Nominal +/-10 units

PRODUCT TOLERANCE

Width: $\pm 0.08"$ (2mm)
Length: $\pm 0.16"$ (4mm)
Thickness: 4mm: $\pm 0.008"$ (0.2mm)
6mm: $\pm 0.012"$ (0.3mm)
Bow: maximum 0.5% of length and/or width
Squareness: maximum 0.2" (5mm)
Peel Strength: >22 in lb/in (ASTM D1781)

ALPOLIC® material is trimmed and squared with cut edges to offer the best panel edge conditions in the industry.

FIRE PERFORMANCE

Fire resistant ALPOLIC®/fr architectural Solid finish panels with a mineral filled core have been tested by independent testing laboratories using nationally recognized tests.

This material meets all requirements of the International Building Code for non-combustible construction:

IBC Listed

Please visit www.alpolic-northamerica.com or call technical support for complete report listings and additional information.

WARRANTY

Standard panel warranty: 10 Year
Finish warranty: 30 Year*
Call ALPOLIC® Customer Service for exclusions and warranty details. *30 year warranty only applies to standard architectural colors.

PRODUCT NOTES

- Panels should be stored flat in a dry, indoor environment.
- Fabricate panels at temperatures above 55°F.
- Protective film should be removed from panels soon after installation.
- Please refer to ALPOLIC®/fr Painted ACM Fabrication Manual for routing and fabrication recommendations.
- Crating fees apply to orders for less than standard piece crate.

**FOR TECHNICAL INFORMATION, PLEASE
CALL 1.800.422.7270**

U.S. HEADQUARTERS

 MITSUBISHI CHEMICAL COMPOSITES AMERICA, INC.

401 Volvo Parkway, Chesapeake, VA 23320
Telephone: 800-422-7270, Facsimile: 757-436-1896
www.alpolic-americas.com e-mail: info@alpolic.com