

# ALPOLIC®

METAL COMPOSITE MATERIALS

MITSUBISHI CHEMICAL COMPOSITES AMERICA, INC.

## architectural – solid

ALPOLIC® architectural Solid color aluminum composite materials are manufactured with a polyethylene core and a 2-coat fluoropolymer paint finish. Distinctive classics of the industry, they are stocked for immediate shipment.

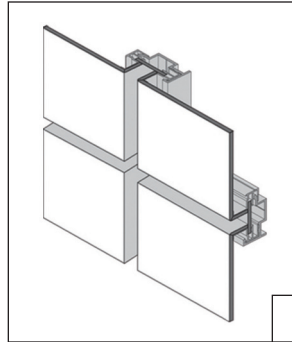

### CONSTRUCTION INFORMATION

PROJECT: Ashland Community College

LOCATION: Grayson, KY

ARCHITECT: Clotfelter-Samokar

PRODUCT: ALPOLIC® Mist White & KDX



### GENERAL INFORMATION

Picture your next project in attractive, clean colors and designs that only our lightweight aluminum composite material (ACM) panels can achieve. They are stocked in two widths – 50 and 62 inches; and two lengths – 146 and 196 inches. These 4mm-thick panels are manufactured to architectural standards with a traditional polyethylene core.

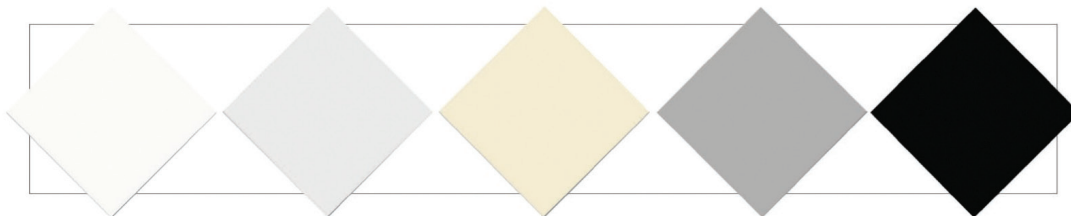

*BONE WHITE*  
4-4BNT-G30

*MIST WHITE*  
4-4MST-G30

*OYSTER*  
4-4CRT-G30

*ALUMINUM GREY*  
4-4AGT-G30

*TOB BLACK*  
4-4TOB-G15

# ALPOLIC®

# solid

INTERIOR AND EXTERIOR SURFACING  
INTERIOR AND EXTERIOR SIGNAGE

## SURFACE TREATMENT

ALPOLIC® architectural Solid color panels are stocked with a FEVE LUMIFLON™ or a PVDF Kynar finish, both are fluoropolymer paint systems that feature excellent durability and weathering for architectural needs. Available stock architectural Solid colors include Bone White, Mist White, Oyster, Aluminum Grey, BGY Grey, and TOB Black.

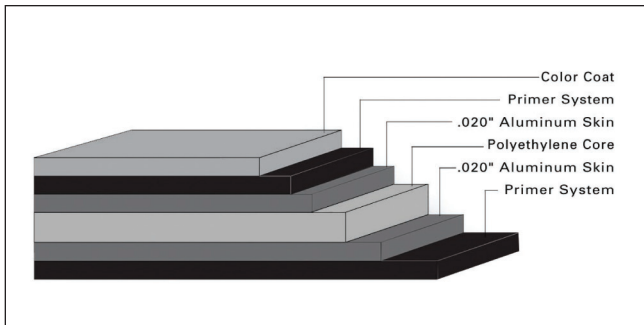

## STANDARD PANEL SIZE

Standard widths are 50" (1270mm) and 62" (1575mm) and lengths of 146" (3708mm) and 196" (4978mm). Panels are stocked in 4mm thickness. Standard crate is 50 pieces. Custom lengths and thickness available. Please contact ALPOLIC® Customer Service for current available stock and additional information.

## FINISH TOLERANCE

Color: DE 1.0 max from standard  
Gloss: Nominal +/- 10 units

## PRODUCT TOLERANCE

Width: ± 0.08" (2mm)  
Length: ± 0.16" (4mm)  
Thickness: 4mm ± 0.008" (0.2mm)  
6mm ± 0.012" (0.3mm)  
Bow: maximum 0.5% of length and/or width  
Squareness: maximum 0.2" (5mm)  
Peel Strength: >22 in lb/in (ASTM D1781)

ALPOLIC® material is trimmed and squared with cut edges to offer the best panel edge conditions in the industry.

## FIRE PERFORMANCE

Standard ALPOLIC® architectural Solid finish panels with a polyethylene core have been tested by independent testing laboratories using nationally recognized tests.

This material meets all requirements of the International Building Code for combustible construction:

IBC Listed  
UL Listed

Please visit [www.alpolic-northamerica.com](http://www.alpolic-northamerica.com) or call technical support for complete report listings and additional information.

## WARRANTY

Standard panel warranty: 10 Year  
Finish warranty: 30 Year\*

Call ALPOLIC® Customer Service for exclusions and warranty details. \*30 year warranty only applies to standard architectural colors.

## PRODUCT NOTES

- Panels should be stored flat in a dry, indoor environment.
- Fabricate panels at temperatures above 55°F.
- Protective film should be removed from panels soon after installation.
- Please refer to ALPOLIC® Painted ACM Fabrication Manual for routing and fabrication recommendations.
- Crating fees apply to orders for less than standard piece crate.

FOR TECHNICAL INFORMATION, PLEASE  
CALL 1.800.422.7270

### U.S. HEADQUARTERS

MITSUBISHI CHEMICAL COMPOSITES AMERICA, INC.

401 Volvo Parkway, Chesapeake, VA 23320

Telephone: 800-422-7270, Facsimile: 757-436-1896

[www.alpolic-americas.com](http://www.alpolic-americas.com) e-mail: [info@alpolic.com](mailto:info@alpolic.com)