

# ALPOLIC®

METAL COMPOSITE MATERIALS

MITSUBISHI CHEMICAL COMPOSITES AMERICA, INC.

## program – solid

ALPOLIC® program Solid materials present you with a full array of unique, eye-catching color options, including a wide range of glosses. We can also customize your order for your particular color or dimension requirements.

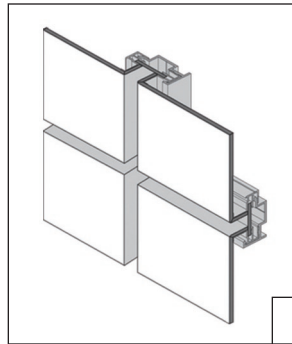

### CONSTRUCTION INFORMATION

PROJECT: Sutliff Chevrolet  
LOCATION: Harrisburg, PA  
ARCHITECT: Victor J. Segina  
PRODUCT: ALPOLIC® CVB Blue & TBX  
Silver Metallic



### GENERAL INFORMATION

ALPOLIC® program Solid panels deliver design and performance advantages inconceivable before now. Whether you choose a 2- or 3-coat finish, we control all coating internally to ensure color correctness. Panels are stocked in either 3mm or 4mm thicknesses.

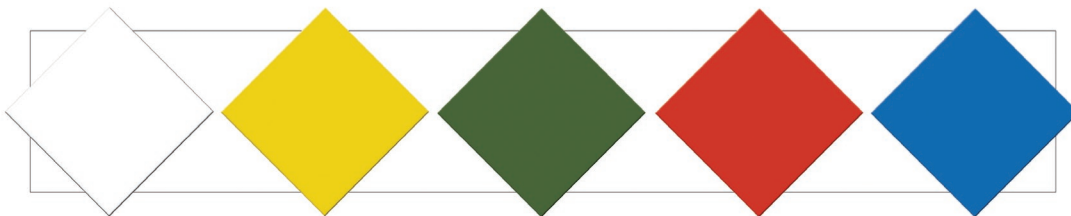

*SAW WHITE*  
3-4SAW-G75

*BYL YELLOW*  
3-4BYL-G50

*BGN GREEN*  
3-4BGN-G50

*FEF RED*  
3-4FEF-G80

*CVB BLUE*  
4-4CVB-G70

# ALPOLIC®

# solid

INTERIOR AND EXTERIOR SURFACING  
INTERIOR AND EXTERIOR SIGNAGE

## SURFACE TREATMENT

ALPOLIC® program Solid color panels are stocked with a FEVE LUMIFLON™ finish, a fluorocarbon paint system that features excellent durability and a color range for program needs. Stock solid finishes exceed 50 colors.

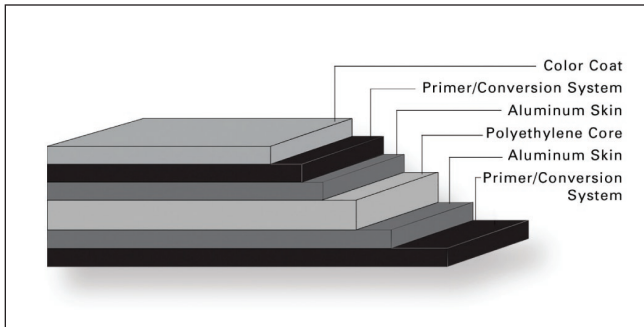

## STANDARD PANEL SIZE

Standard stock sizes and thickness vary by product program. Please contact Customer Service for stock sizes. Standard crate is 75 pieces for 3mm and 50 for 4mm. Custom thickness, widths, lengths are available, along with a fire resistant core. Please contact Customer Service for current available stock and additional information.

## FINISH TOLERANCE

Color: DE 1.0 max from standard  
Gloss: Nominal +/- 10 units

## PRODUCT TOLERANCE

Width: ± 0.08" (2mm)  
Length: ± 0.16" (4mm)  
Thickness: 3mm: ± 0.008" (0.2mm)  
4mm ± 0.008" (0.2mm)  
6mm ± 0.012" (0.3mm)  
Bow: maximum 0.5% of length and/or width  
Squareness: maximum 0.2" (5mm)

ALPOLIC® material is trimmed and squared with cut edges to offer the best panel edge conditions in the industry.

## FIRE PERFORMANCE

Standard ALPOLIC® program Solid finish panels with a polyethylene core have been tested by independent testing laboratories using nationally recognized tests.

This material meets all requirements of the International Building Code for combustible construction:

IBC Listed for all .020/.020 products  
UL Listed

Please visit [www.alpolic-northamerica.com](http://www.alpolic-northamerica.com) or call technical support for complete report listings and additional information.

## WARRANTY

Standard panel warranty:	10 Year
Finish warranty: 3mm	10 Year
4mm	20 Year

Call ALPOLIC® Customer Service for exclusions and warranty details.

## PRODUCT NOTES

- Panels should be stored flat in a dry, indoor environment.
- Fabricate panels at temperatures above 55°F.
- Protective film should be removed from panels soon after installation.
- Please refer to ALPOLIC® Painted ACM Fabrication Manual for routing and fabrication recommendations.
- Crating fees apply to orders for less than standard piece crate.

FOR TECHNICAL INFORMATION, PLEASE  
CALL 1.800.422.7270

### U.S. HEADQUARTERS

MITSUBISHI CHEMICAL COMPOSITES AMERICA, INC.

401 Volvo Parkway, Chesapeake, VA 23320

Telephone: 800-422-7270, Facsimile: 757-436-1896

[www.alpolic-america.com](http://www.alpolic-america.com) e-mail: [info@alpolic.com](mailto:info@alpolic.com)