

# ALPOLIC®

METAL COMPOSITE MATERIALS

MITSUBISHI CHEMICAL COMPOSITES AMERICA, INC.

## stone series

ALPOLIC®/fr Stone Series give you the genuine look and strength of stone, but in the form of an innovative, high-performance and lightweight aluminum composite material (ACM) – the best of both worlds for architects and designers.

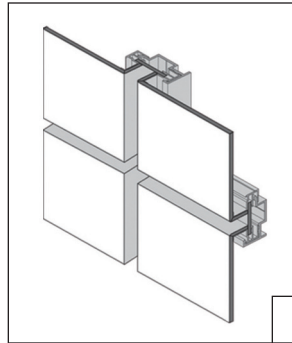

### CONSTRUCTION INFORMATION

PROJECT: Macy's Department Store  
LOCATION: Las Vegas, NV  
PRODUCT: ALPOLIC® Black Granite & White Granite



### GENERAL INFORMATION

ALPOLIC® Stone Series has the look, feel and rigidity of stone and weathered copper at only a fraction of the weight. That and the standard mineral filled fire resistant core makes it perfect for building cladding, modular buildings, fascia, accent bands, canopies, column covers and signage. Its combination of durability and natural beauty makes this series a classic.

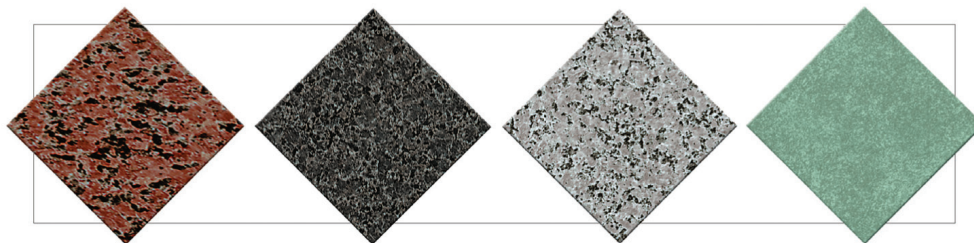

RED GRANITE  
4-4LRG-G80

BLACK GRANITE  
4-4LBG-G80

WHITE GRANITE  
4-4LWG-G80

PATINA COPPER  
4-4PSS-G30

# ALPOLIC® /fr

# stone

INTERIOR AND EXTERIOR SURFACING  
INTERIOR AND EXTERIOR SIGNAGE

## SURFACE TREATMENT

ALPOLIC®/fr Stone panels are created through a unique image transfer process using state-of-the-art fluoropolymer paint technology. Stone Series offers a range of surface treatments that includes Red Granite, Black Granite, White Granite, White Marble, and Patina Copper.

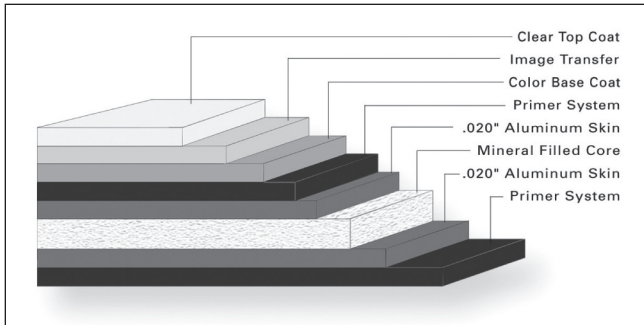

## STANDARD PANEL SIZE

Standard stock width is 62" (1575mm) and lengths of 146" (3708mm) and 196" (4978mm). Panels are stocked in 4mm thickness. Standard crate is 30 pieces. Please contact ALPOLIC® Customer Service for current available stock and additional information.

## FINISH TOLERANCE

Color: Visual match to standard  
Gloss: Nominal +/- 10 units

## PRODUCT TOLERANCE

Width: ± 0.08" (2mm)  
Length: ± 0.16" (4mm)  
Thickness: 4mm ± 0.008" (0.2mm)  
6mm ± 0.012" (0.3mm)  
Bow: maximum 0.5% of length and/or width  
Squareness: maximum 0.2" (5mm)  
Peel Strength: >22 in lb/in (ASTM D1781)

ALPOLIC® material is trimmed and squared with cut edges to offer the best panel edge conditions in the industry.

## FIRE PERFORMANCE

Fire resistant ALPOLIC®/fr Stone finish panels with a mineral filled core have been tested by independent testing laboratories using nationally recognized tests.

This material meets all requirements of the International Building Code for non-combustible construction:

IBC Listed

Please visit [www.alpolic-northamerica.com](http://www.alpolic-northamerica.com) or call technical support for complete report listings and additional information.

## WARRANTY

Standard panel warranty: 10 Year  
Finish warranty: 20 Year  
Call ALPOLIC® Customer Service for exclusions and warranty details.

## PRODUCT NOTES

- Panels should be stored flat in a dry, indoor environment.
- Fabricate panels at temperatures above 55°F.
- Protective film should be removed from panels soon after installation.
- Please refer to ALPOLIC®/fr Fabrication Manual for routing and fabrication recommendations.
- Crating fees apply to orders for less than standard piece crate.

**FOR TECHNICAL INFORMATION, PLEASE  
CALL 1.800.422.7270**

### U.S. HEADQUARTERS

MITSUBISHI CHEMICAL COMPOSITES AMERICA, INC.

401 Volvo Parkway, Chesapeake, VA 23320

Telephone: 800-422-7270, Facsimile: 757-436-1896

[www.alpolic-americas.com](http://www.alpolic-americas.com) e-mail: [info@alpolic.com](mailto:info@alpolic.com)